

# ACARA™

## Assembly Instructions

AFC150-PC Series • AFC250-PC Series

Power Connector for use in APP-Schaffner • Filtered Connection System

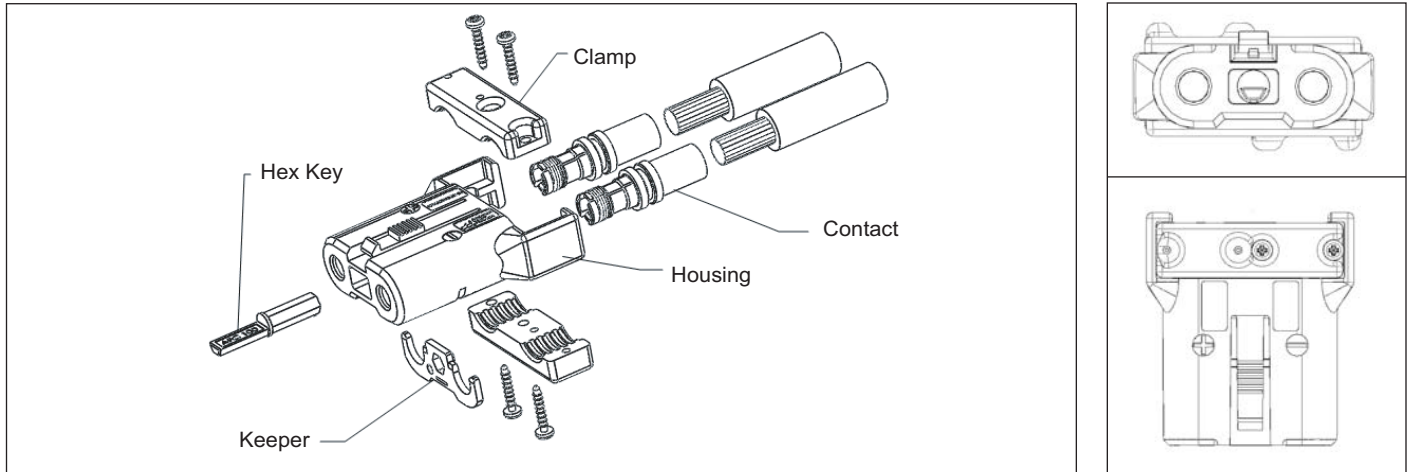

FOR INSTALLATION BY A QUALIFIED ELECTRICIAN IN ACCORDANCE WITH NATIONAL AND LOCAL ELECTRICAL CODES AND THE FOLLOWING INSTRUCTIONS. THE SUITABILITY OF THIS TYPE OF TERMINATION MUST BE EVALUATED BY UNDERWRITER'S LABORATORIES, INC., AND CANADIAN STANDARDS ASSOCIATION FOR THE END USE APPLICATION.

PART NUMBER	AMPS	WIRE SIZE (Class I, M) (IEC Class 5)	WIRE STRIP LENGTH in. [mm]	TOOL	DIE	CRIMPS	LOCATOR
AFC150-PC/1/0	150	1/0 AWG	1.10[30]	1387G2	1303G2	1	1304G16
AFC250-PC/2/0	195	2/0 AWG	1.24[31]	1387G2	1303G3	1	1304G17
AFC250-PC/4/0	250	4/0 AWG	1.24[31]	1387G2	1303G3	1	1304G17
AFC150-PC/M50	150	50mm <sup>2</sup>	1.10[30]	1387G2	1303G12	1	1304G16
AFC250-PC/M70	195	70mm <sup>2</sup>	1.24[31]	1387G2	1303G3	1	1304G17
AFC250-PC/M95	250	95mm <sup>2</sup>	1.24[31]	1387G2	1303G3	1	1304G17

### Assembly Instructions:

- Strip conductor insulation to length indicated in table.
- Insert conductor strand into barrel of socket contact. Crimp using pneumatic tool, die, locator and number of crimps indicated in table. (\*Where applicable, first insert conductor strands into adaptor bushing supplied; then insert bushing into barrel of socket contact).
- Insert terminated conductors into connector housing; insert keeper into groove in connector housing and snap into place.
- Orient hex key as desired, and insert into power connector housing as shown, through hole in keeper and snap into place.
- Assemble clamp halves onto conductor insulation; insert screws into four screw holes; advance screws with #2 Philips drive torque to 20 lb-in [2.3 N-m].

Underwriter's Laboratories, Inc. Recognized Component, File E26226 • Semko 400358 • Warning: Utmost caution should be used when working on live connector contacts • ACARA connectors are Patent Pending. ACARA & APP are registered US & foreign trademarks of Anderson Power Products, 13 Pratts Junction Rd., P.O. Box 579, Sterling, MA 01564



Anderson Power Products®  
13 Pratts Junction Road, P.O. Box 579  
Sterling, MA 01564 / USA  
T:978-422-3600 F:978-422-3700  
www.andersonpower.com



Schaffner EMC Inc.  
52 Mayfield Avenue, Edison, New Jersey 08837 / USA  
T: +1 732 225 9533 Toll free: 0800 367 5566 F: +1 732 225 4789

# ACARA™

## Assembly Instructions

AFC150-FA/ -FB Series • AFC250-FA/ -FB Series

Filter Connector for use in APP-Schaffner • Filtered Connection System

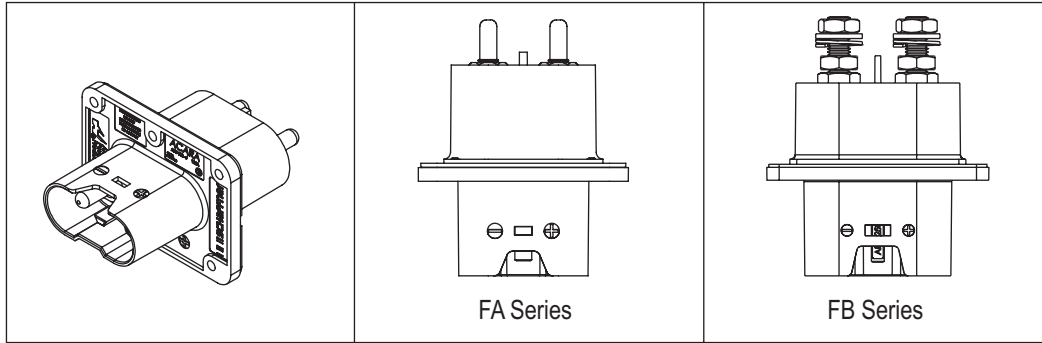

PART NUMBER	CLASS	MAX. VOLTS	AMPS	nF	MOUNTING HARDWARE	BUSBAR CONTACT	TERMINAL LUG
AFC150-FA/A0470	Y2	300	150	470	M6	2-8486G2	-----
AFC150-FB/A0470	Y2	300	150	470	M6	-----	1/0 AWG/ 50mm
AFC150-FA/A0220	Y2	300	150	220	M6	2-8486G2	-----
AFC150-FB/A0220	Y2	300	150	220	M6	-----	1/0 AWG/ 50mm <sup>2</sup>
AFC150-FA/B1000	Y4	130	150	1000	M6	2-8486G2	-----
AFC150-FB/B1000	Y4	130	150	1000	M6	-----	1/0 AWG/ 50mm <sup>2</sup>
AFC150-FA/B2100	Y4	130	150	2100	M6	2-8486G2	-----
AFC150-FB/B2100	Y4	130	150	2100	M6	-----	1/0 AWG/ 50mm <sup>2</sup>
AFC250-FA/A0220	Y2	300	250	220	M6	2-8486G2	-----
AFC250-FB/A0220	Y2	300	250	220	M6	-----	4/0 AWG/ 95mm <sup>2</sup>
AFC250-FA/A0470	Y2	300	250	470	M6	2-8486G2	-----
AFC250-FB/A0470	Y2	300	250	470	M6	-----	4/0 AWG/ 95mm <sup>2</sup>
AFC250-FA/B1000	Y4	130	250	1000	M6	2-8486G2	-----
AFC250-FB/B1000	Y4	130	250	1000	M6	-----	4/0 AWG/ 95mm <sup>2</sup>
AFC250-FA/B2100	Y4	130	250	2100	M6	2-8486G2	-----
AFC250-FB/B2100	Y4	130	250	2100	M6	-----	4/0 AWG/ 95mm <sup>2</sup>

### TYPICAL EFFECT OF GROUND QUALITY ON INSERTION LOSS PERFORMANCE

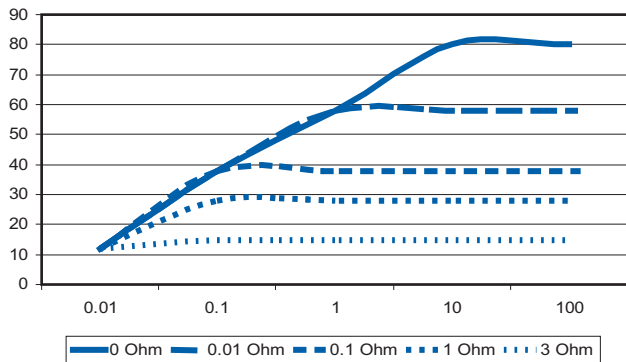

### Assembly Instructions:

1. Recommended mounting with metric machine screws, nuts and lockwashers specified onto conductive surface of equipment.
2. Torque mounting screws to 22 lb-in [2.5 N-m].
3. --FB types: terminal lug mounting torque not to exceed 26 LB-FT [35 N-m].

### PANEL CUT-OUT

### PANEL CONDUCTIVE AREA, AND MOUNTING HOLE PATTERN

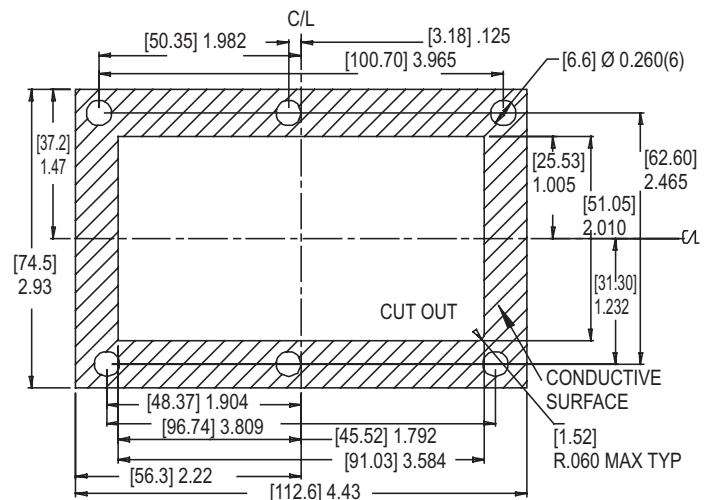

Underwriter's Laboratories, Inc. Recognized Component, File E26226 • Semko 403270 • Warning: Utmost caution should be used when working on live connector contacts • ACARA connectors are Patent Pending. ACARA & APP are registered US & foreign trademarks of Anderson Power Products, 13 Pratts Junction Rd., P.O. Box 579, Sterling, MA 01564

**APP**  
Anderson Power Products®  
13 Pratts Junction Road, P.O. Box 579  
Sterling, MA 01564 / USA  
T:978-422-3600 F:978-422-3700  
www.andersonpower.com

**SCHAFNER**  
Schaffner EMC Inc.  
52 Mayfield Avenue, Edison, New Jersey 08837 / USA  
T: +1 732 225 9533 Toll free: 0800 367 5566 F: +1 732 225 4789