

# PowerMod® HP "A" Series Female Dual Pole Panel Mount Connector Assembly Instructions



Contact

Connector Housing

Keeper

- 1) Strip wire per the picture shown :  
7/8 inch  
[22.2 mm]



- 2) Insert wire into the female contact contact making sure wire bottoms out in the barrel. Make sure all strands are in the contact barrel. Select a crimping tool system from the chart below.

Wire Size	Pneumatic Production Tool				Hand Tool			
	Part Number	Die P/N	Locator P/N	Number of Crimps	Hydraulic	Battery	Die P/N	Number of Crimps
#2 AWG 35mm <sup>2</sup>	1387G2	1303G13	1304G19	2	1387G3	1370	1322G7	2
25mm <sup>2</sup>	1387G2	1303G13	1304G19	2	1387G3	1370	1322G11	2
#4 AWG	1387G2	1303G14	1304G19	2	1387G3	1370	1322G8	2
16mm <sup>2</sup>	1387G2	1303G14	1304G19	2	1387G3	1370	1322G10	2
#6 AWG	1387G2	1303G14	1304G19	2	1387G3	1370	1322G9	2

- 3) Crimp the contact barrel



- 4) Insert the crimped contacts into the contact keeper. Contacts should fit snugly in each "C" shaped opening.



# PowerMod® HP "A" Series Female Dual Pole Panel Mount Connector

Page 2

- 5) Slide keeper/contact assembly into the connector housing verifying that the wire/contact is located in the proper position (A or B). Keeper will snap into the openings on the top and bottom of the connector housing. Visually inspect the openings to assure the keeper is seated. The C shaped raised area on both sides of the keeper should be clearly visible. If required, the contact/keeper assembly can be removed from the housing using a pair of needle nose pliers

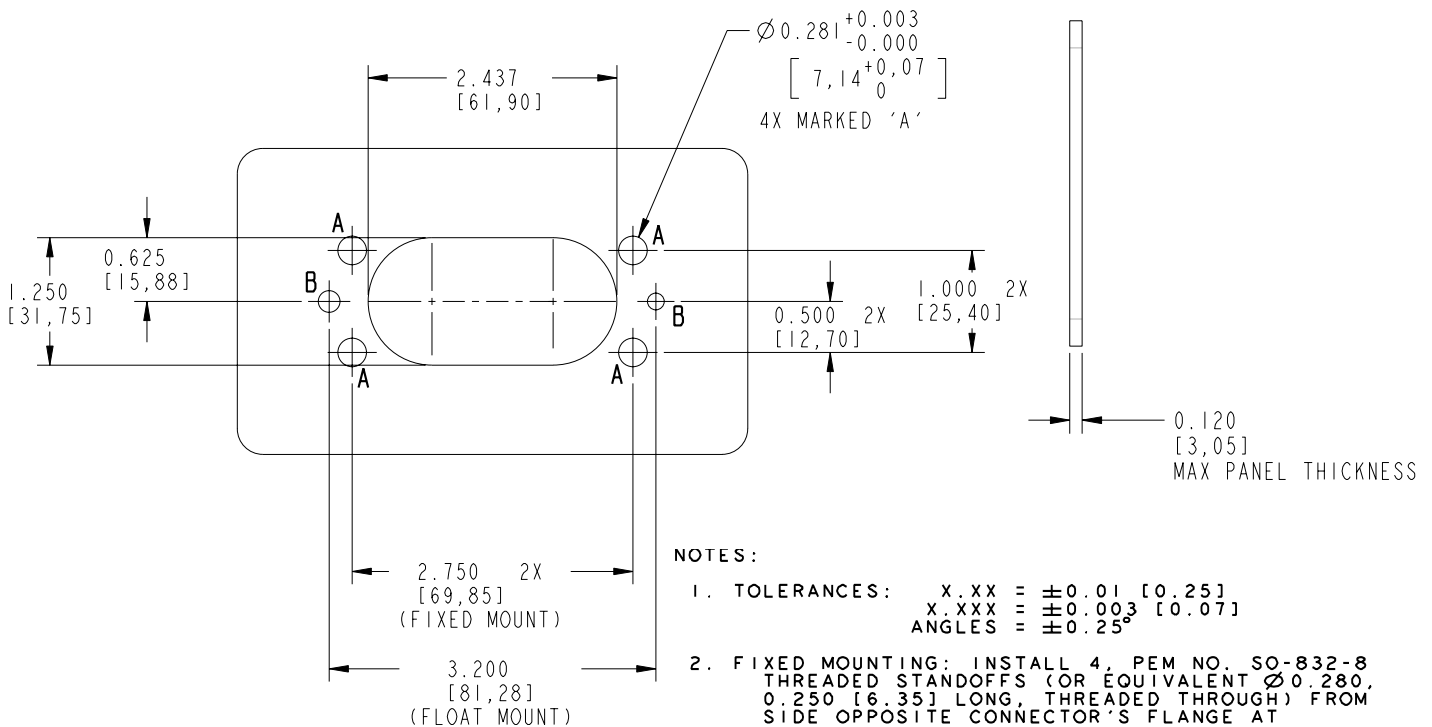

**NOTES:**

1. TOLERANCES: X.XX = ±0.01 [0.25]  
X.XXX = ±0.003 [0.07]  
ANGLES = ±0.25°
2. FIXED MOUNTING: INSTALL 4, PEM NO. SO-832-8 THREADED STANDOFFS (OR EQUIVALENT Ø0.280, 0.250 [6.35] LONG, THREADED THROUGH) FROM SIDE OPPOSITE CONNECTOR'S FLANGE AT LOCATIONS MARKED 'A'. METRIC; USE PEM NO. SO-M4-6 OR EQUIVALENT.
3. FIXED CONNECTOR REQUIRES AND AREA OF THE PANEL 3.62 [92] WIDE, 1.59 [40.4] HIGH.
4. FLOAT MOUNTING:  
METHOD 1: INSTALL 2, 8-32 OR M4 CAPTIVE STUDS FROM SIDE OPPOSITE CONNECTOR'S FLANGE AT LOCATIONS MARKED 'B'. PROTRUDING LENGTH OF STUD MUST BE AT LEAST 0.50 [12.7]. (FOR USE WITH KEP NUT WITH CAPTIVE CONICAL WASHER AND SHOULDER WASHER 2-8555PI)  
METHOD 2: INSTALL 2, 8-32 OR M4 CAPTIVE NUTS FROM SIDE OPPOSITE CONNECTOR'S FLANGE AT LOCATIONS MARKED 'B'. (FOR USE WITH SEMS SCREW WITH CAPTIVE CONICAL WASHER AND SHOULDER WASHER 2-8555PI)
5. FLOATING CONNECTOR REQUIRES AN AREA OF THE PANEL 4.00 [101.6] WIDE, 1.85 [47] HIGH.

**WARNING**  
NEVER WORK WITH LIVE CONDUCTORS

**PATENTS AND TRADEMARKS**

This product is Patent Pending.  
"PowerMod", "A" in a circle and "Anderson Power Products" are registered U.S. and foreign trademarks of Anderson Power Products, 13 Pratts Junction Road, P.O. Box 579, Sterling, MA 01564 USA

1S6439 ASM-ADPPMF REV03

HEADQUARTERS: 13 Pratts Junction Road, P.O. Box 579, Sterling, MA 01564 T:978-422-3600 F:978-422-3700

EUROPE: Rately Road, Fermoy Co. Cork, Ireland T:353-(0)25-32277 F:353-(0)25-32296

ASIA/PACIFIC: IDEAL Anderson Asia Pacific Ltd., Unit 922-928 Topsail Plaza, 11 On Sum Street, Shatin N.T., Hong Kong T:852-2636-0836 F:852-2635-9036

www.andersonpower.com