

PowerMod® HP “B” Series Female Dual Pole Panel Mount Connector Assembly Instructions



Contact

Connector Housing

Keeper

- 1) Strip wire per the picture shown :

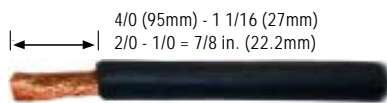

- 2) Insert wire into the female contact contact making sure wire bottoms out in the barrel. Make sure all strands are in the contact barrel. Select a crimping tool system from the chart below.

| Wire Size | Pneumatic Production Tool | | | | Hand Tool | | | | Hydraulic Tool | |
|-----------------------|---------------------------|---------|-------------|------------------|-----------|---------|---------|------------------|----------------|------------------|
| | Part Number | Die P/N | Locator P/N | Number of Crimps | Hydraulic | Battery | Die P/N | Number of Crimps | Part Number | Number of Crimps |
| 4/0 | 1387G2 | 1303G3 | 1304G25 | 2 | 1387G3 | 1370 | 1322G14 | 2 | 1368 | 2 |
| 95mm ² | 1387G2 | 1303G17 | 1304G25 | 2 | 1387G3 | 1370 | 1322G1 | 2 | 1368 | 2 |
| 2/0-70mm ² | 1387G2 | 1303G16 | 1304G23 | 2 | 1387G3 | 1370 | 1322G3 | 2 | 1368 | 2 |
| 1/0-50mm ² | 1387G2 | 1303G8 | 1304G23 | 2 | 1387G3 | 1370 | 1322G13 | 2 | 1368 | 2 |

- 3) Crimp the contact barrel



- 4) Insert the crimped contacts into the contact keeper. Contacts should fit snugly in each “C” shaped opening.



PowerMod® HP "B" Series Female Dual Pole Panel Mount Connector

Page 2

- 5) Slide keeper/contact assembly into the connector housing verifying that the wire/contact is located in the proper position (A or B). Keeper will snap into the openings on the top and bottom of the connector housing. Visually inspect the openings to assure the keeper is seated. The C shaped raised area on both sides of the keeper should be clearly visible. If required, the contact/keeper assembly can be removed from the housing using a pair of needle nose pliers

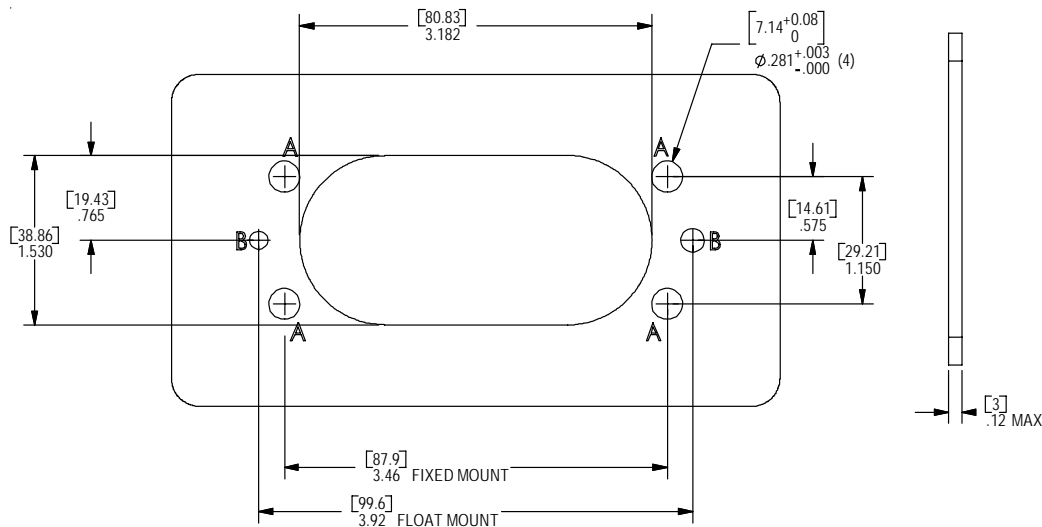

NOTES:

1. TOLERANCES: X.XX = ± 0.01 [0.25]
X.XXX = ± 0.003 [0.07]
ANGLES = $\pm 0.25^\circ$
2. FIXED MOUNTING: INSTALL 4, PEM NO. SO-832-8 THREADED STANDOFFS (OR EQUIVALENT $\varnothing 0.280$, 0.250 [6.35] LONG, THREADED THROUGH) FROM SIDE OPPOSITE CONNECTOR'S FLANGE AT LOCATIONS MARKED 'A'. METRIC; USE PEM NO. SO-M4-6 OR EQUIVALENT.
3. FIXED CONNECTOR REQUIRES AN AREA OF THE PANEL 3.62 [92] WIDE, 1.59 [40.4] HIGH.
4. FLOAT MOUNTING:
METHOD 1: INSTALL 2, 8-32 OR M4 CAPTIVE STUDS FROM SIDE OPPOSITE CONNECTOR'S FLANGE AT LOCATIONS MARKED 'B'. PROTRUDING LENGTH OF STUD MUST BE AT LEAST 0.50 [12.7]. (FOR USE WITH KEP NUT WITH CAPTIVE CONICAL WASHER AND SHOULDER WASHER 2-8555P1)
METHOD 2: INSTALL 2, 8-32 OR M4 CAPTIVE NUTS FROM SIDE OPPOSITE CONNECTOR'S FLANGE AT LOCATIONS MARKED 'B'. (FOR USE WITH SEMS SCREW WITH CAPTIVE CONICAL WASHER AND SHOULDER WASHER 2-8555P1)
5. FLOATING CONNECTOR REQUIRES AN AREA OF THE PANEL 4.59 [116.6] WIDE, 2.12 [53.8] HIGH.

WARNING

NEVER WORK WITH LIVE CONDUCTORS

PATENTS AND TRADEMARKS

This product is Patent Pending.

"PowerMod", "A" in a circle and "Anderson Power Products" are registered U.S. and foreign trademarks of Anderson Power Products, 13 Pratts Junction Road, P.O. Box 579, Sterling, MA 01564 USA

1S6460 ASM-BDPPMF REV01

HEADQUARTERS: 13 Pratts Junction Road, P.O. Box 579, Sterling, MA 01564 T:978-422-3600 F:978-422-3700

EUROPE: Rately Road, Fermoy Co. Cork, Ireland T:353-(0)25-32277 F:353-(0)25-32296

ASIA/PACIFIC: IDEAL Anderson Asia Pacific Ltd., Unit 922-928 Topsail Plaza, 11 On Sum Street, Shatin N.T., Hong Kong T:852-2636-0836 F:852-2635-9036

www.andersonpower.com